

Name of Organization [Bismarck Parks and Recreation District](#)

Federal Tax ID# [45-0409352](#)

Contact Person/Title [Randy Bina, Executive Director](#)

Address [400 E. Front Avenue](#)

City [Bismarck](#)

State [North Dakota](#)

Zip Code [58503](#)

E-mail Address [rbina@bisparks.org](mailto:rbina@bisparks.org)

Web Site Address [www.bisparks.org](http://www.bisparks.org)

Phone [701-222-6455](#)

Fax # [701-221-6838](#)

List names of co-applicants if this is a joint proposal

[The Myron Atkinson family, who donated the land is providing input and funding toward the project.](#)

**MAJOR Directive:**

Choose only one response

☐ **Directive A.** Providing access to private and public lands for sportsmen, including projects that create fish and wildlife habitat and provide access for sportsmen;

☐ **Directive B.** Improving, maintaining and restoring water quality, soil conditions, plant diversity, animal systems and by supporting other practices of stewardship to enhance farming and ranching;

☐ **Directive C.** Developing, enhancing, conserving and restoring wildlife and fish habitat on private and public lands; and

☒ **Directive D.** Conserving natural areas and creating other areas for recreation through the establishment and development of parks and other recreation areas.

**Additional Directive:**

Choose all that apply

☒ **Directive A.** Providing access to private and public lands for sportsmen, including projects that create fish and wildlife habitat and provide access for sportsmen;

☒ **Directive B.** Improving, maintaining and restoring water quality, soil conditions, plant diversity, animal systems and by supporting other practices of stewardship to enhance farming and ranching;

☒ **Directive C.** Developing, enhancing, conserving and restoring wildlife and fish habitat on private and public lands; and

☐ **Directive D.** Conserving natural areas and creating other areas for recreation through the establishment and development of parks and other recreation areas.

**Type of organization:**

☐ State Agency

☒ Political Subdivision

☐ Tribal Entity

☐ Tax-exempt, nonprofit corporation.

**Project Name** **Atkinson Nature Park Improvements**

**Abstract/Executive Summary. (no more than 500 words)**

Atkinson Nature Park is a 138-acre wooded preserve area, currently used only for a horse trail. Atkinson Nature Park was donated to Bismarck Parks and Recreation District (BPRD) by the Myron Atkinson family for use as a conservation and recreational space. The 138 acres are predominantly wooded with a few clearings, and also includes a waterway that winds through the site. The wooded nature of the park makes it a unique natural area in the Bismarck-Mandan community. The proposed project, designed with input from the Atkinson family, includes the addition of a hiking trail, interpretive program, an overlook area and also has a conservation component. The plan includes a small gravel parking lot and trailhead signs, which will increase public access to this park. The total project costs are... and the project is expected to start in the spring of 2018, with construction concluded in the fall of 2018.

**Hiking & Horse Trails**

In 2017, a 1.65 mile horse trail was cleared through Atkinson Nature Park, which is directly south of the Walt Neuens Horse Arena. In order to allow greater public access to this piece of land, BPRD has decided to open up this park space to the public to allow all residents and visitors the opportunity to enjoy and explore this wooded, natural gem in the heart of Bismarck. The current 1.65 mile trail loop will be expanded to include an overlook area, an interpretive signage program, and a connection to the existing BPRD shared-use trail. The

trail would only allow hiking and horse use, and would not allow for any motorized or any wheeled recreation, including mountain bikes. Trailhead signs near the proposed gravel parking lot will educate the public about why this area will be open only to foot traffic. In order to invite the public in to Atkinson Nature Park, the project will also include a new park sign along Riverwood Drive, and a shared access point with the Horse Arena.

### **Conservation & Interpretation**

In addition to creating a hiking trail system, BPRD would also initiate a more active conservation plan, including eradication of invasive species in the wooded areas and along the waterway. These species include Purple Loosestrife, which currently exists in the waterway. BPRD will also continue with a succession plan for trees in this area that were damaged in the 2011 flood and/or are reaching the end of their lifespan. Both of these efforts will help to preserve the soil health, vegetation, and fish and wildlife habitat on the site.

BPRD also plans to provide an interpretation/education program with four interpretive signs along the trail focusing on birding, a popular sport in Bismarck. This site has both wooded acreage and a waterway, making it an amazing place to view all sorts of wildlife, especially birds.

**Project Duration:** Project will begin in Summer 2018 and construction will wrap up in Spring/Summer 2019. Eradication of invasive species will continue until threat is gone.

**Amount of Grant request \$ 21,830**

**Total Project Costs \$ 57,830**

(Note that in-kind and indirect costs can be used for matching funds)

**A minimum of 25% Match Funding is required. Amount of Matching Funds \$ 36,000**

Please indicate if the matching funds will be in-kind, indirect or cash.

### **Source(s) of Matching Funds\***

<b>Funding Source</b>	<b>Amount</b>
BPRD Cash Match	\$ 15,900
BPRD in-kind labor	\$ 4,200
Myron Atkinson Family	\$ 15,900
<b>Total Matching Funds</b>	<b>\$36,000.00</b>

### **Certifications \***

☒ I certify that this application has been made with the support of the governing body and chief executive of my organization.

☒ I certify that if awarded grant funding none of the funding will be used for any of the exemptions noted on Page 1 of this application.

## **Narrative**

**Organization Information** – Briefly summarize your organization's history, mission, current programs and activities. \*

Include an overview of your organizational structure, including board, staff and volunteer involvement. (no more than 300 words)

Since 1927, Bismarck Parks and Recreation District (BPRD) has provided parks, trails, facilities and programs for all Bismarck residents and visitors. BPRD has a governing board of five elected members, a full-time staff of 62, and a seasonal, part-time staff of over 900, not including volunteers.

BPRD's mission is to work with the community to provide residents and visitors the highest quality park, program, facility and event experience. BPRD's Core Purpose is to provide affordable, accessible and sustainable public park and recreation services. BPRD sustains over 250 partnerships and creative collaborations that are the foundation for diverse and dynamic recreational opportunities, efficient and rewarding joint use of public facilities, coordinated programming and alternative funding. From horse arenas to hockey, from public art to pickle ball and pollinator gardens, from trails to tennis, BPRD provides community opportunities and impact.

In 2008, BPRD became the first – and is still the only – accredited agency in North Dakota. BPRD is a 2017 Gold Medal recipient, the highest and most prestigious honor in the parks and recreation profession. Bismarck was named ND's first Playful City USA in 2008 and still holds that designation. For 90 years, BPRD's unique relationships, community support, leadership and shared resources have made a permanent impact on the quality of life in Bismarck.

**Purpose of Grant** – Describe the proposed project identifying how the project will meet the specific directive(s) of the Outdoor Heritage Fund Program \*

### **Recreational Opportunities**

The proposed plan for the Atkinson Nature Park is to provide a 1.65 mile hiking trail loop with an overlook and interpretive program. The trail loop will also provide a trail connection to an existing paved, shared-use trail to the north of the Horse Arena site. The hiking trail will be cleared and mowed as necessary to provide a safe and enjoyable trail experience. This trail will be a shared trail with hikers and horses, and will be identified as such on the trailhead sign near the proposed gravel parking lot. The new site configuration will include a new entry sign for the Atkinson Nature Park on Riverwood Drive and a shared entrance with the Horse Arena. Please see attached plan for additional details.

### **Sportsperson Opportunities & Interpretation**

By allowing easier access to the Atkinson Nature Park with a hiking trail, entry sign and small, gravel parking lot, BPRD intends to attract many more sportspersons to the site, especially birders. Due to the unique juxtaposition of riparian woods with a waterway, birds are plentiful at the Atkinson Nature Park. BPRD intends to encourage birding by providing an interpretive program. The program will include four interpretive signs along the trail highlighting birds that are common to the site, as well as those that visit with migratory patterns. The plan also includes an overlook seating area that has an amazing view of the waterway and riparian flats for better viewing opportunities.

## Conservation

BPRD plans to conserve and enhance the wooded lands and waterways to support wildlife and fish habitats, as well as soil and plant health with a two pronged approach. BPRD will create a succession plan by planting understory trees that are native to the riparian ecosystem (see attached plan). The planting plan includes four different species of trees and will be planted in accordance with the USDA-NRCS planting specifications. Number, location and species are provided on the attached plan. With many of the old growth trees surviving the 2011 flood with possible damage, the succession plan is time-sensitive in order to maintain the integrity of the site.

In addition to the succession plantings, BPRD will work diligently to remove invasive species in the wooded areas and in the waterway, including, but not limited to, already identified purple loosestrife. BPRD will provide in-kind services toward this eradication of invasive species so that the program is sustainable.

## Management of Project – Provide a description of how you will manage and oversee the project to ensure it is carried out on schedule and in a manner that best ensures its objectives will be met.\*

Include a brief background and work experience for those managing the project.

BPRD Operations Director will oversee the project. Our Operations Director has a background in landscape architecture and project management and over 15 years' experience in parks, recreation, and conservation areas. BPRD has a proven track record with grants and grant fulfillment, meeting all deadlines and providing adequate records.

## Evaluation – Describe your plan to document progress and results. \*

How will you tell if the project is successful? Please be specific on the methods you will utilize to measure success. Note that regular reporting, final evaluation and expenditure reports will be required for every grant awarded.

Conservation measures will be evident in number of trees planted, trail miles installed, signs installed the first season and percentage of invasive species eradicated each year. BPRD will also use informal counting measures to gauge the usage of the hiking trail.

## Financial Information

ATTACHMENT: **Project Budget – Using the standard project budget format that is available on the website at <http://www.nd.gov/ndic/outdoor-infopage.htm> , please include a detailed total project budget that specifically outlines all the funds you are requesting. Note that a minimum of 25% match funding is required.\***

The project budget should identify all matching funds, funding sources and indicate whether the matching funds are in the form of cash or in-kind services. Effective July 1, 2015 no State General Fund dollars can be used for a match unless funding was legislatively appropriated for that purpose. As noted on the standard project budget format, certain values have been identified for in-kind services. Please utilize these values in identifying your matching funds. **NOTE: No indirect costs will be funded.**

X I certify that a project budget will be sent to the Commission\* See below

## Project Budget

Outdoor Heritage Fund - Project Budget					
Project Expense	OHF Request	Applicant's Match Share (Cash)	Applicant's Match Share (In-Kind)	Other Project Sponsor's Share	Total Each Project Expense
Parking Lot/Fencing	\$ 13,030	\$ 15,900	\$	\$	\$ 28,930
Signs/Furnishings	\$	\$	\$	\$ 9,900	\$ 9,900
Interpretive Program	\$ -	\$	\$ 1,200	4,800	\$ 6,000
Plantings/Conservation	\$ 8,800	\$	\$ 3,000	1,200	\$ 13,000
<b>Total Costs</b>	<b>\$ 21,830</b>	<b>\$ 15,900</b>	<b>\$ 4,200</b>	<b>\$ 15,900</b>	<b>\$ 57,830</b>

## Project Cost Estimate – [Quotes are attached](#)

Atkinson Nature Park - Trailhead & Park Improvements Cost Estimate				
	QTY	UNIT	PRICE	TOTAL PRICE
PARKING LOT/FENCING				
Gravel & Grading	1	LS	\$ 9,680	\$ 9,680
Fencing	1	LS	\$ 15,250	\$ 15,250
Gate	1	LS	\$ 4,000	\$ 4,000
	Parking Lot/Fencing Total			\$ 28,930
SIGNS/FURNISHINGS				
Benches	4	EA	\$ 1,000	\$ 4,000
Picnic Tables	2	EA	\$ 1,200	\$ 2,400
Entry Sign	1	EA	\$ 500	\$ 500
Trailhead Sign	1	EA	\$ 2,500	\$ 2,500
Trail Markers/Stickers	1	LS	\$ 500	\$ 500
		Furnishings Total		\$ 9,900
INTERPRETIVE PROGRAM				
Interpretive Signs	4	EA	\$ 1,200	\$ 4,800
Interpretive Sign Artwork (labor)	80	Hr	\$ 15	\$ 1,200
	Interpretive Program Total			\$ 6,000
PLANTINGS/CONSERVATION				
Trees	40	EA	\$ 250	\$ 10,000
Invasive Species Eradication (labor)	200	Hr	\$ 15	\$ 3,000
	Plantings/Conservation Total			\$ 13,000
			TOTAL	\$ 57,830

**Sustainability** – Indicate how the project will be funded or sustained in future years. \*

Include information on the sustainability of this project after all the funding from the Outdoor Heritage Fund has been expended and whether the sustainability will be in the form of ongoing management or additional funding from a different source.

BPRD will continue to manage the Atkinson Nature Park, including ongoing maintenance, invasive species eradication as needed, and additional clearing and underplanting as needed.

**Partial Funding** – Indicate how the project will be affected if less funding is available than that requested. \*

The project would move forward, but would be implemented in phases and the scope of the project may be scaled back.

**Partnership Recognition** - If you are a successful recipient of Outdoor Heritage Fund dollars, how would you recognize the Outdoor Heritage Fund partnership? \*

All partners, including the Outdoor Heritage Fund will be recognized on the trailhead sign by the proposed parking lot. In addition, BPRD will recognize OHF in any press releases and social media blasts once the project is completed.



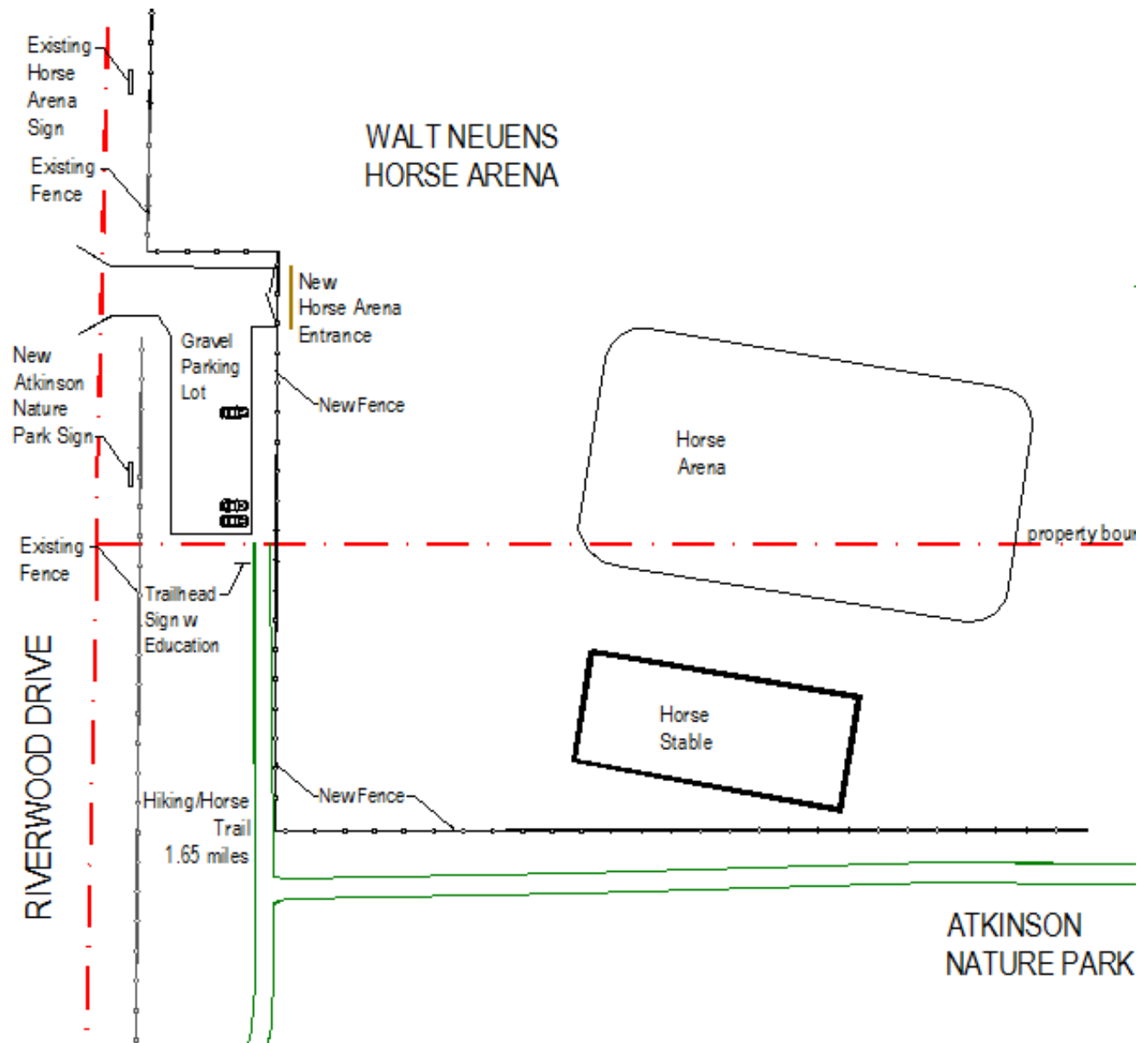

**Atkinson Nature Park Improvement Plan**  
*Entry/Trailhead Site Plan*







TREE PLANTING SPECIFICATIONS

	COMMON NAME	SCIENTIFIC NAME	SIZE	TYPE	QTY
	Bur Oak	<i>Quercus macrocarpa</i>	2" Caliper	B & B	8
	Prairie Expedition American Elm	<i>Ulmus americana 'Lewis &amp; Clark'</i>	2" Caliper	B & B	8
	Eastern Cottonwood	<i>Populus deltoids</i>	2" Caliper	B & B	8
	American Linden	<i>Tilia americana</i>	2" Caliper	B & B	8
	Common Hackberry	<i>Celtis occidentalis</i>	2" Caliper	B & B	8

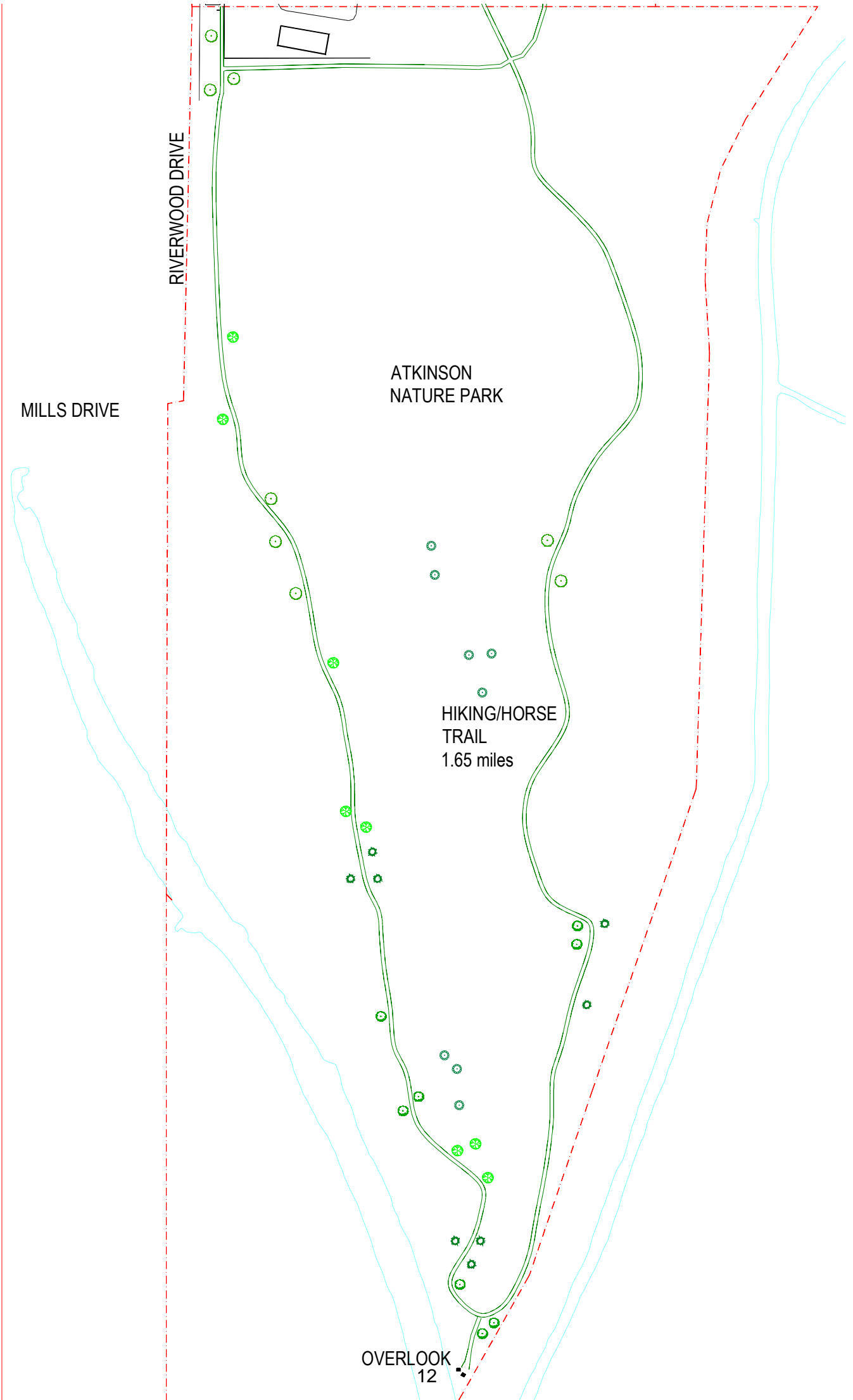

Name of Organization [Bismarck Parks and Recreation District](#)

Federal Tax ID# [45-0409352](#)

Contact Person/Title [Randy Bina, Executive Director](#)

Address [400 E. Front Avenue](#)

City [Bismarck](#)

State [North Dakota](#)

Zip Code [58503](#)

E-mail Address [rbina@bisparks.org](mailto:rbina@bisparks.org)

Web Site Address [www.bisparks.org](http://www.bisparks.org)

Phone [701-222-6455](#)

Fax # [701-221-6838](#)

List names of co-applicants if this is a joint proposal

[The Myron Atkinson family, who donated the land is providing input and funding toward the project.](#)

**MAJOR Directive:**

Choose only one response

☐ **Directive A.** Providing access to private and public lands for sportsmen, including projects that create fish and wildlife habitat and provide access for sportsmen;

☐ **Directive B.** Improving, maintaining and restoring water quality, soil conditions, plant diversity, animal systems and by supporting other practices of stewardship to enhance farming and ranching;

☐ **Directive C.** Developing, enhancing, conserving and restoring wildlife and fish habitat on private and public lands; and

☒ **Directive D.** Conserving natural areas and creating other areas for recreation through the establishment and development of parks and other recreation areas.

**Additional Directive:**

Choose all that apply

☒ **Directive A.** Providing access to private and public lands for sportsmen, including projects that create fish and wildlife habitat and provide access for sportsmen;

☒ **Directive B.** Improving, maintaining and restoring water quality, soil conditions, plant diversity, animal systems and by supporting other practices of stewardship to enhance farming and ranching;

☒ **Directive C.** Developing, enhancing, conserving and restoring wildlife and fish habitat on private and public lands; and

☐ **Directive D.** Conserving natural areas and creating other areas for recreation through the establishment and development of parks and other recreation areas.

**Type of organization:**

☐ State Agency

☒ Political Subdivision

☐ Tribal Entity

☐ Tax-exempt, nonprofit corporation.

**Project Name** **Atkinson Nature Park Improvements**

**Abstract/Executive Summary. (no more than 500 words)**

Atkinson Nature Park is a 138-acre wooded preserve area, currently used only for a horse trail. Atkinson Nature Park was donated to Bismarck Parks and Recreation District (BPRD) by the Myron Atkinson family for use as a conservation and recreational space. The 138 acres are predominantly wooded with a few clearings, and also includes a waterway that winds through the site. The wooded nature of the park makes it a unique natural area in the Bismarck-Mandan community. The proposed project, designed with input from the Atkinson family, includes the addition of a hiking trail, interpretive program, an overlook area and also has a conservation component. The plan includes a small gravel parking lot and trailhead signs, which will increase public access to this park. The total project costs are... and the project is expected to start in the spring of 2018, with construction concluded in the fall of 2018.

**Hiking & Horse Trails**

In 2017, a 1.65 mile horse trail was cleared through Atkinson Nature Park, which is directly south of the Walt Neuens Horse Arena. In order to allow greater public access to this piece of land, BPRD has decided to open up this park space to the public to allow all residents and visitors the opportunity to enjoy and explore this wooded, natural gem in the heart of Bismarck. The current 1.65 mile trail loop will be expanded to include an overlook area, an interpretive signage program, and a connection to the existing BPRD shared-use trail. The



trail would only allow hiking and horse use, and would not allow for any motorized or any wheeled recreation, including mountain bikes. Trailhead signs near the proposed gravel parking lot will educate the public about why this area will be open only to foot traffic. In order to invite the public in to Atkinson Nature Park, the project will also include a new park sign along Riverwood Drive, and a shared access point with the Horse Arena.

### **Conservation & Interpretation**

In addition to creating a hiking trail system, BPRD would also initiate a more active conservation plan, including eradication of invasive species in the wooded areas and along the waterway. These species include Purple Loosestrife, which currently exists in the waterway. BPRD will also continue with a succession plan for trees in this area that were damaged in the 2011 flood and/or are reaching the end of their lifespan. Both of these efforts will help to preserve the soil health, vegetation, and fish and wildlife habitat on the site.

BPRD also plans to provide an interpretation/education program with four interpretive signs along the trail focusing on birding, a popular sport in Bismarck. This site has both wooded acreage and a waterway, making it an amazing place to view all sorts of wildlife, especially birds.

**Project Duration:** Project will begin in Summer 2018 and construction will wrap up in Spring/Summer 2019. Eradication of invasive species will continue until threat is gone.

**Amount of Grant request \$ 21,830**

**Total Project Costs \$ 57,830**

(Note that in-kind and indirect costs can be used for matching funds)

**A minimum of 25% Match Funding is required. Amount of Matching Funds \$ 36,000**

Please indicate if the matching funds will be in-kind, indirect or cash.

### **Source(s) of Matching Funds\***

<b>Funding Source</b>	<b>Amount</b>
BPRD Cash Match	\$ 15,900
BPRD in-kind labor	\$ 4,200
Myron Atkinson Family	\$ 15,900
Total Matching Funds	\$36,000.00

### **Certifications \***

X I certify that this application has been made with the support of the governing body and chief executive of my organization.

X I certify that if awarded grant funding none of the funding will be used for any of the exemptions noted on Page 1 of this application.

## **Narrative**

**Organization Information** – Briefly summarize your organization's history, mission, current programs and activities. \*

Include an overview of your organizational structure, including board, staff and volunteer involvement. (no more than 300 words)

Since 1927, Bismarck Parks and Recreation District (BPRD) has provided parks, trails, facilities and programs for all Bismarck residents and visitors. BPRD has a governing board of five elected members, a full-time staff of 62, and a seasonal, part-time staff of over 900, not including volunteers.

BPRD's mission is to work with the community to provide residents and visitors the highest quality park, program, facility and event experience. BPRD's Core Purpose is to provide affordable, accessible and sustainable public park and recreation services. BPRD sustains over 250 partnerships and creative collaborations that are the foundation for diverse and dynamic recreational opportunities, efficient and rewarding joint use of public facilities, coordinated programming and alternative funding. From horse arenas to hockey, from public art to pickle ball and pollinator gardens, from trails to tennis, BPRD provides community opportunities and impact.

In 2008, BPRD became the first – and is still the only – accredited agency in North Dakota. BPRD is a 2017 Gold Medal recipient, the highest and most prestigious honor in the parks and recreation profession. Bismarck was named ND's first Playful City USA in 2008 and still holds that designation. For 90 years, BPRD's unique relationships, community support, leadership and shared resources have made a permanent impact on the quality of life in Bismarck.

**Purpose of Grant** – Describe the proposed project identifying how the project will meet the specific directive(s) of the Outdoor Heritage Fund Program \*

### **Recreational Opportunities**

The proposed plan for the Atkinson Nature Park is to provide a 1.65 mile hiking trail loop with an overlook and interpretive program. The trail loop will also provide a trail connection to an existing paved, shared-use trail to the north of the Horse Arena site. The hiking trail will be cleared and mowed as necessary to provide a safe and enjoyable trail experience. This trail will be a shared trail with hikers and horses, and will be identified as such on the trailhead sign near the proposed gravel parking lot. The new site configuration will include a new entry sign for the Atkinson Nature Park on Riverwood Drive and a shared entrance with the Horse Arena. Please see attached plan for additional details.

### **Sportsperson Opportunities & Interpretation**

By allowing easier access to the Atkinson Nature Park with a hiking trail, entry sign and small, gravel parking lot, BPRD intends to attract many more sportspersons to the site, especially birders. Due to the unique juxtaposition of riparian woods with a waterway, birds are plentiful at the Atkinson Nature Park. BPRD intends to encourage birding by providing an interpretive program. The program will include four interpretive signs along the trail highlighting birds that are common to the site, as well as those that visit with migratory patterns. The plan also includes an overlook seating area that has an amazing view of the waterway and riparian flats for better viewing opportunities.

## Conservation

BPRD plans to conserve and enhance the wooded lands and waterways to support wildlife and fish habitats, as well as soil and plant health with a two pronged approach. BPRD will create a succession plan by planting understory trees that are native to the riparian ecosystem (see attached plan). The planting plan includes four different species of trees and will be planted in accordance with the USDA-NRCS planting specifications. Number, location and species are provided on the attached plan. With many of the old growth trees surviving the 2011 flood with possible damage, the succession plan is time-sensitive in order to maintain the integrity of the site.

In addition to the succession plantings, BPRD will work diligently to remove invasive species in the wooded areas and in the waterway, including, but not limited to, already identified purple loosestrife. BPRD will provide in-kind services toward this eradication of invasive species so that the program is sustainable.

## Management of Project – Provide a description of how you will manage and oversee the project to ensure it is carried out on schedule and in a manner that best ensures its objectives will be met.\*

Include a brief background and work experience for those managing the project.

BPRD Operations Director will oversee the project. Our Operations Director has a background in landscape architecture and project management and over 15 years' experience in parks, recreation, and conservation areas. BPRD has a proven track record with grants and grant fulfillment, meeting all deadlines and providing adequate records.

## Evaluation – Describe your plan to document progress and results. \*

How will you tell if the project is successful? Please be specific on the methods you will utilize to measure success. Note that regular reporting, final evaluation and expenditure reports will be required for every grant awarded.

Conservation measures will be evident in number of trees planted, trail miles installed, signs installed the first season and percentage of invasive species eradicated each year. BPRD will also use informal counting measures to gauge the usage of the hiking trail.

## Financial Information

ATTACHMENT: **Project Budget – Using the standard project budget format that is available on the website at <http://www.nd.gov/ndic/outdoor-infopage.htm> , please include a detailed total project budget that specifically outlines all the funds you are requesting. Note that a minimum of 25% match funding is required.\***

The project budget should identify all matching funds, funding sources and indicate whether the matching funds are in the form of cash or in-kind services. Effective July 1, 2015 no State General Fund dollars can be used for a match unless funding was legislatively appropriated for that purpose. As noted on the standard project budget format, certain values have been identified for in-kind services. Please utilize these values in identifying your matching funds. **NOTE: No indirect costs will be funded.**

X I certify that a project budget will be sent to the Commission\* See below

## Project Budget

Outdoor Heritage Fund - Project Budget					
Project Expense	OHF Request	Applicant's Match Share (Cash)	Applicant's Match Share (In-Kind)	Other Project Sponsor's Share	Total Each Project Expense
Parking Lot/Fencing	\$ 13,030	\$ 15,900	\$	\$	\$ 28,930
Signs/Furnishings	\$	\$	\$	\$ 9,900	\$ 9,900
Interpretive Program	\$ -	\$	\$ 1,200	4,800	\$ 6,000
Plantings/Conservation	\$ 8,800	\$	\$ 3,000	1,200	\$ 13,000
<b>Total Costs</b>	<b>\$ 21,830</b>	<b>\$ 15,900</b>	<b>\$ 4,200</b>	<b>\$ 15,900</b>	<b>\$ 57,830</b>

## Project Cost Estimate – [Quotes are attached](#)

Atkinson Nature Park - Trailhead & Park Improvements Cost Estimate				
	QTY	UNIT	PRICE	TOTAL PRICE
PARKING LOT/FENCING				
Gravel & Grading	1	LS	\$ 9,680	\$ 9,680
Fencing	1	LS	\$ 15,250	\$ 15,250
Gate	1	LS	\$ 4,000	\$ 4,000
	Parking Lot/Fencing Total			\$ 28,930
SIGNS/FURNISHINGS				
Benches	4	EA	\$ 1,000	\$ 4,000
Picnic Tables	2	EA	\$ 1,200	\$ 2,400
Entry Sign	1	EA	\$ 500	\$ 500
Trailhead Sign	1	EA	\$ 2,500	\$ 2,500
Trail Markers/Stickers	1	LS	\$ 500	\$ 500
		Furnishings Total		\$ 9,900
INTERPRETIVE PROGRAM				
Interpretive Signs	4	EA	\$ 1,200	\$ 4,800
Interpretive Sign Artwork (labor)	80	Hr	\$ 15	\$ 1,200
	Interpretive Program Total			\$ 6,000
PLANTINGS/CONSERVATION				
Trees	40	EA	\$ 250	\$ 10,000
Invasive Species Eradication (labor)	200	Hr	\$ 15	\$ 3,000
	Plantings/Conservation Total			\$ 13,000
			TOTAL	\$ 57,830



**Sustainability** – Indicate how the project will be funded or sustained in future years. \*

Include information on the sustainability of this project after all the funding from the Outdoor Heritage Fund has been expended and whether the sustainability will be in the form of ongoing management or additional funding from a different source.

BPRD will continue to manage the Atkinson Nature Park, including ongoing maintenance, invasive species eradication as needed, and additional clearing and underplanting as needed.

**Partial Funding** – Indicate how the project will be affected if less funding is available than that requested. \*

The project would move forward, but would be implemented in phases and the scope of the project may be scaled back.

**Partnership Recognition** - If you are a successful recipient of Outdoor Heritage Fund dollars, how would you recognize the Outdoor Heritage Fund partnership? \*

All partners, including the Outdoor Heritage Fund will be recognized on the trailhead sign by the proposed parking lot. In addition, BPRD will recognize OHF in any press releases and social media blasts once the project is completed.



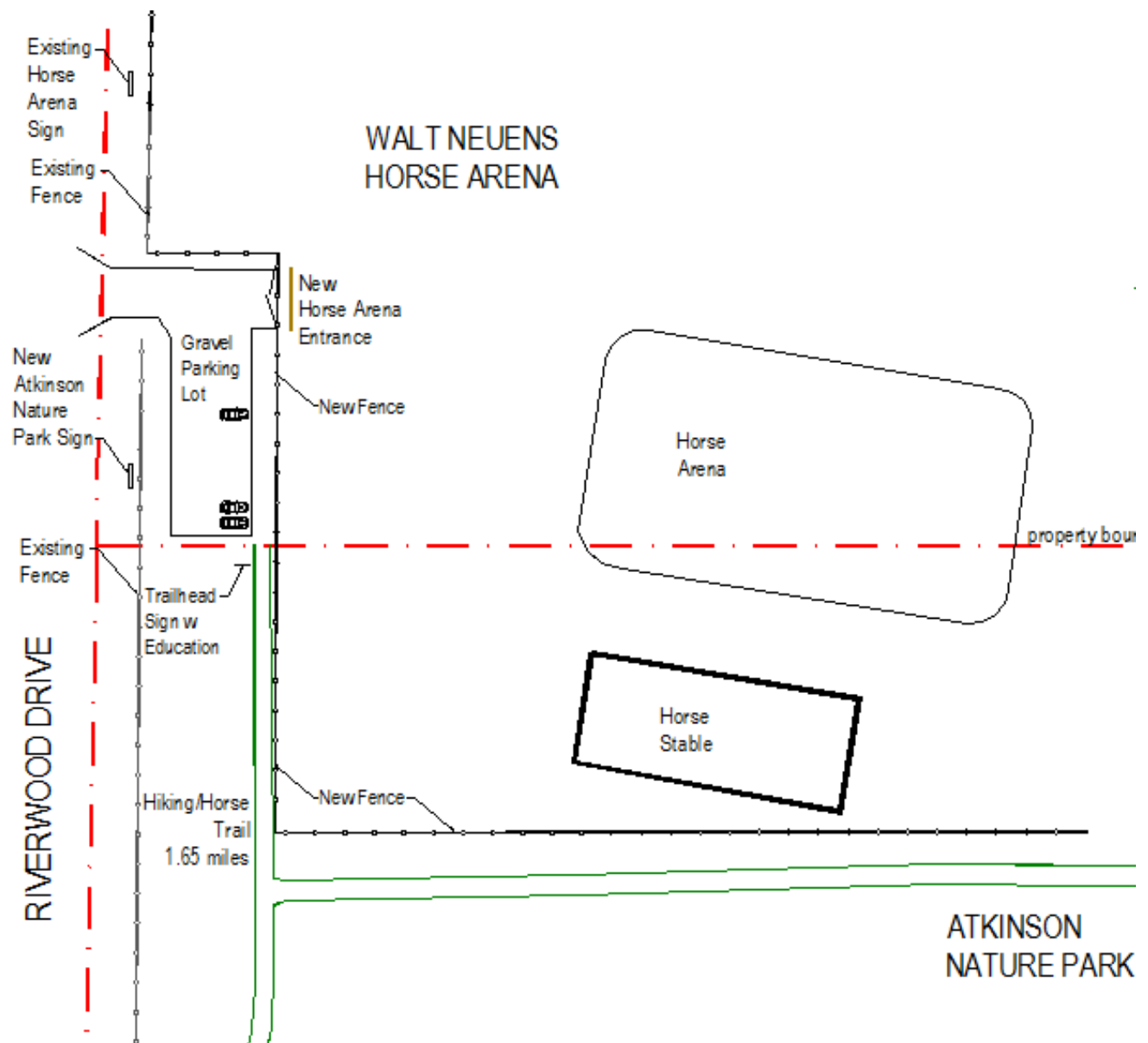

**Atkinson Nature Park Improvement Plan**  
*Entry/Trailhead Site Plan*



Atkinson Nature Park Improvement Plan  
Hiking/Horse Trail Plan



TREE PLANTING SPECIFICATIONS

	COMMON NAME	SCIENTIFIC NAME	SIZE	TYPE	QTY
	Bur Oak	<i>Quercus macrocarpa</i>	2" Caliper	B & B	8
	Prairie Expedition American Elm	<i>Ulmus americana 'Lewis &amp; Clark'</i>	2" Caliper	B & B	8
	Eastern Cottonwood	<i>Populus deltoids</i>	2" Caliper	B & B	8
	American Linden	<i>Tilia americana</i>	2" Caliper	B & B	8
	Common Hackberry	<i>Celtis occidentalis</i>	2" Caliper	B & B	8





# WEISZ

**& SONS INC**  
**CONTRACTORS**  
Bismarck, ND • 701-258-9770

Proposal Submitted to: Bismarck Parks & Recreation District 400 E Front Ave. Bismarck, ND 58504 Attn: David Mayer	Phone 701-222-6464	Date: March 23, 2018
Job Name: Neuens Horse Arena	Job Location: Bismarck, ND	

## PROPOSAL

### Scope of work included in our price:

- Mobilization
- Remove topsoil
- Subgrade preparation including compaction.
- Import approximately 220 Ton of Class 5 gravel, water and place at a compacted thickness of 6".
- Replace topsoil against gravel edge.

L.S. Price \$ 9,680.00

### Exclusions

- Testing, barricades, traffic or pedestrian control, or payment and performance bond.
- This work is based on working after load limits.

We propose hereby to furnish material and labor – complete in accordance with above specifications and clarifications, for the sum of Dollars \$ See Above

Payment to be made as follows: Upon Completion.

All material is guaranteed to be as specified. All work to be completed in a workmanlike manner according to standard practices. Any alteration or deviation from above specifications involving extra costs will be executed only upon written orders, and will become an extra charge over and above the estimate. All agreements contingent upon strikes, accidents, or delays beyond our control. Owner to carry fire, tornado, and other necessary insurance. Our workers are fully covered by Workman's Compensation Insurance.

Authorized Signature Don Weisz Date 3-23-18

(Note: This proposal may be withdrawn by us if not accepted within 30 days.)

Acceptance of Proposal, the above price, specification and conditions are satisfactory and are hereby accepted. You are authorized to do the work as specified. Payments will be made as outlined above. **Any questions call Don Weisz at 701-391-3552.**

Authorized Signature \_\_\_\_\_ Date \_\_\_\_\_

# Dakota Fence®

FARGO, ND  
BISMARCK, ND  
MINOT, ND  
WILLISTON, ND

1720 S 12<sup>th</sup> St • P.O. Box 62 • Bismarck, ND 58502-0062  
800-726-4062 • Bismarck 701-258-9095 • Fax 701-223-3140  
Dickinson 701-483-1919  
E-mail: sales@dakotafence.com Website: www.dakotafence.com



PROPOSAL SUBMITTED TO <b>Bismarck Parks and Recreation</b>	PHONE <b>(701) 222-6464</b>	DATE <b>3/29/18</b>
STREET <b>400 E Front Ave</b>	JOB NAME <b>Walt Neuens Horse Arena</b>	
CITY, STATE AND ZIP CODE <b>Bismarck ND 58504</b>	JOB LOCATION <b>Bismarck ND</b>	

We hereby submit specifications and estimates for:

We propose to furnish all labor, material and equipment necessary to complete the following:

Install approximately 745 LF of 6' high chain link fence. All posts to be pounded in the ground. Price includes moving existing pole entrance to new location.

**Total Installed - \$ 15,250.00**

## Notes:

- Dakota Fence is a member of OSCA, ECCS, DISA, PEC Premier, and ISNetworld for safety and security.
- Price does not include clearing, grubbing, staking, survey, grading, gravel, or seeding of the fence line.
- Price does not include hydro excavation of holes in the event of encountering underground utilities.
- Price does not include Bond, add \$8.20 / \$1,000.00 if needed.
- Priced for installation during the 2018 construction season, and does not include frozen weather conditions.
- As Built Drawings will not be provided by Dakota Fence.
- Electrical grounding of the fence and gates is not included in the price above and shall be done by others if required.
- ND state law, Chapter 49-23, (underground utility locates) may require up to 96 hours before work can commence.

We Propose hereby to furnish material and labor - complete in accordance with above specifications, for the sum of:

As per above

dollars (\$ \_\_\_\_\_).

Terms of Payment to be made as follows: Upon Completion

Purchaser agrees to indemnify and hold harmless Dakota Fence and its agents from any and all claims or damages arising directly or indirectly from any failure to erect fence, guardrail or other products on or within property lines; any failure to comply with by-laws, restrictive covenants, building codes or other restrictions; encroachment or interference with any easement; damage to any improvements, including underground sprinklers, utilities, including wires or pipes; frost heave; personal injury or death. Purchaser agrees that Dakota Fence's liability shall not exceed the amount paid to it under this Proposal. Purchaser agrees to be responsible for removal of posthole soil or Dakota Fence shall dispose of posthole soil for an additional charge. All work to be completed according to standard industry practices. Purchaser agrees that any alteration or deviation from the above prices or specifications requires Dakota Fence's prior written consent and shall automatically become part of and subject to this Proposal, which may include an additional charge. This proposal contingent upon strikes, accidents or delays beyond Dakota fence's control and supersedes all prior written or oral agreements. Purchaser agrees to carry all necessary and required insurance. Dakota Fence's workers are fully covered by Workers Compensation Insurance or other required insurance. Unless objected by Purchaser, Dakota Fence shall place a lawn sign on the property for the duration of Dakota Fence's work.

**Acceptance of Proposal** The above prices, specifications, terms and conditions are satisfactory and hereby accepted by Purchaser. Dakota Fence is authorized to do the work as specified and Purchaser shall make payment as outlined above

Date of Acceptance \_\_\_\_\_

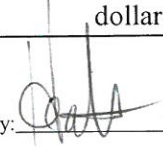
By:  \_\_\_\_\_  
Heather Kautz  
Dakota Fence

This Proposal may be withdrawn by Dakota Fence within 15 days.

**Purchaser**

Purchaser Name: \_\_\_\_\_

By: \_\_\_\_\_

Print Name \_\_\_\_\_

Its: \_\_\_\_\_



## PROPOSAL