

Stanley City Council

Gary Weisenberger, Mayor
Jacob Hellman
Zach Gaaskjolen
Ty Taylor
Linda Wienbar
Tim Holte
David Minton



208 S. Main St.
PO Box 249
Stanley, ND 58784-0249
701-628-2225 Phone
701-628-2232 Fax
1-800-366-6888 TTY

allyn@stanleynd.us

April 24, 2019

North Dakota Industrial Commission
Attn: Outdoor Heritage Fund Program
State Capitol – Fourteenth Floor
600 East Boulevard Ave. Dept. 405
Bismarck, ND 58505

Dear Honorable Members of the Outdoor Heritage Advisory Committee:

Enclosed please find our application for OHF grant funding for a shared use pathway to the Stanley City Pond. Your consideration to approve our worthwhile project as a recommended project to the ND Industrial Commission is greatly appreciated.

We would be happy to provide any additional information that is needed on our behalf. We look forward to meeting with the OHF Advisory Board to present our project.

Sincerely,

A handwritten signature in black ink that reads "Gary Weisenberger". The signature is written in a cursive, flowing style.

Gary Weisenberger, Mayor
Stanley City Council

Outdoor Heritage Fund Grant Application



Instructions

After completing the form, applications and supporting documentation may be submitted by mail to North Dakota Industrial Commission, ATTN: Outdoor Heritage Fund Program, State Capitol – Fourteenth Floor, 600 East Boulevard Ave. Dept. 405, Bismarck, ND 58505 or by e-mail to outdoorheritage@nd.gov. It is preferred that both a hard copy and electronic copy are submitted.

You are not limited to the spacing provided, except in those instances where there is a limit on the number of words. If you need additional space, please indicate that on the application form, answer the question on a separate page, and include with your submission.

The application and all attachments must be received or postmarked by the application deadline. You will be sent a confirmation by e-mail of receipt of your application. You may submit your application at any time prior to the application deadline. **Applicants are strongly encouraged to submit applications prior to the deadline for staff review in order ensure that proposals will be complete when submitted on deadline date.** Incomplete applications may not be considered for funding.

Please review the back of this form to determine project eligibility, definitions, budget criteria, and statutory requirements.

Project Name [Main Street to Stanley City Pond Shared Use Pathway](#)

Name of Organization [City of Stanley](#)

Federal Tax ID# [45-6002160](#)

Contact Person/Title [Allyn Sveen, Stanley City Auditor](#)

Address [PO Box 249](#)

City [Stanley](#)

State [ND](#)

Zip Code [58784-0249](#)

E-mail Address allyn@stanleynd.us

Web Site Address (Optional) www.stanleynd.com

Phone [701-628-2225](#)

Fax # (if available) [701-628-2232](#)

List names of co-applicants if this is a joint proposal

MAJOR Directive:

Choose only one response

- Directive A.** Providing access to private and public lands for sportsmen, including projects that create fish and wildlife habitat and provide access for sportsmen;
- Directive B.** Improving, maintaining and restoring water quality, soil conditions, plant diversity, animal systems and by supporting other practices of stewardship to enhance farming and ranching;
- Directive C.** Developing, enhancing, conserving and restoring wildlife and fish habitat on private and public lands; and
- Directive D.** Conserving natural areas and creating other areas for recreation through the establishment and development of parks and other recreation areas.

Additional Directive:

Choose all that apply

- Directive A.**
- Directive B.**
- Directive C.**
- Directive D.**

Type of organization:

- State Agency
- Political Subdivision
- Tribal Entity
- Tax-exempt, nonprofit corporation.

Abstract/Executive Summary.

Summarize the project, including its objectives, expected results, duration, total project costs and participants. (no more than 500 words)

The City of Stanley is applying for grant funding through the ND Outdoor Heritage Program to construct a shared use pathway to provide access to the Stanley City Pond and Stanley Scout Facility from Main Street. A new pathway would be constructed along the north side of 1st Avenue SE and Reservoir Road from 1st Street SE to the Stanley Pond/Stanley Scout Facility. In 2017, the City of Stanley deeded property adjacent the Stanley City Pond to the

Stanley Scouts. The City maintains public access within the deeded property and along the Stanley City Pond. The Scouts have spent over \$1,000,000 providing a beautiful facility for the Scouts and the community and they continue to make improvements. The Scouts will provide in-kind match funds for the shared use pathway project.

Outdoor enthusiasts are attracted to this area to enjoy fishing, camping, bird watching and to enjoy the natural beauty of the area. The improvements by the Scouts has contributed to making the area around the City Pond more attractive offering amenities such as a shooting range, meeting rooms providing for water and gun safety education and handicap accessible restroom facilities,. The Scouts have long term goals to provide a picnic area, an observation deck and nesting site and other activities encouraging youth activity. In 2004, the ND Game & Fish Department and the Stanley Lions Club sponsored a handicap accessible fishing pier at the Stanley City Pond. The Game & Fish Department stocks the Pond with adult catfish and rainbow trout.

The current access to the City Pond and the fishing pier is poor for the general public and is not accessible to the disabled. Reservoir Road is a heavily traveled gravel road, and the access within is a prairie trail. The shared use pathway would provide a safe route to the City Pond for outdoor enthusiast of all ages and provide a handicap accessible pathway. The pathway from the Scout facility will allow a disabled individual to park their vehicle and use a wheelchair from the building to the handicap accessible fishing pier. As development is enhanced to and at the Stanley City Pond, increased usage is anticipated. The Scouts will attract hundreds of people being able to hosts camps, trainings and many sportsmen events.

Stanley City will use Brosz Engineering to help facilitate the project. The Scouts will provide in-kind assistance with tree planting along the shared pathway and near their new facility. Scouts will construct the pathway from their building to the parking lot. Stanley City would afford any matching cost not met with in-kind contributions. After construction, Stanley City personnel will provide maintenance of the share use pathway.

This project is just the beginning; the opportunities are unlimited for the development within this area. The close proximity to Stanley allows youth and adults to fish throughout the season without having to travel great distances. The City Pond and the facilities within introduces youth to lifelong activities that can be enjoyed by the entire family.

Project Duration: Preliminary planning in 2019, construction in 2020 with completion by October 30, 2020.

Indicate the intended schedule for drawing down OHF funds.

OHF funds for 2019 would consist of preliminary engineering costs, remaining OHF funds would be drawn down in 2020 for construction and construction engineering costs. Anticipated project completion would be October 30, 2020.

Amount of Grant request: \$ 496,425.00

Total Project Costs: \$ 661,900.00

Note: in-kind and indirect costs can be used for matching funds.

Amount of Matching Funds: \$ 165,475.00

A minimum of 25% Match Funding is required. Indicate if the matching funds will be in-kind, indirect or cash. Please provide verification that these matching funds are available for your project. Note that effective as of July 1, 2015 no State General Fund dollars can be used for a match unless funding was legislatively appropriated for that purpose.

| Amount of Match | Funding Source | Type of Match |
|-----------------|--|--|
| \$ 10,500.00 | Scouts | <input type="checkbox"/> Cash <input checked="" type="checkbox"/> <u>In-Kind •(Trees)</u> <input type="checkbox"/> Indirect |
| \$ 135,975.00 | City of Stanley – City Sales Tax and/or Oil & Gas Production Tax Funding | <input checked="" type="checkbox"/> <u>Cash •</u> <input type="checkbox"/> In-Kind <input type="checkbox"/> Indirect |
| \$ 19,000.00 | Boy Scout Troop 1357 | <input type="checkbox"/> Cash <input checked="" type="checkbox"/> <u>In-Kind •(Pathway – Scout Building to Parking Lot)</u> <input type="checkbox"/> Indirect |
| \$ | | <input type="checkbox"/> Cash <input type="checkbox"/> In-Kind <input type="checkbox"/> Indirect |
| \$ | | <input type="checkbox"/> Cash <input type="checkbox"/> In-Kind <input type="checkbox"/> Indirect |
| \$ | | <input type="checkbox"/> Cash <input type="checkbox"/> In-Kind <input type="checkbox"/> Indirect |

Certifications

- I certify that this application has been made with the support of the governing body and chief executive of my organization.
- I certify that if awarded grant funding none of the funding will be used for any of the exemptions noted in the back of this application.

Narrative

Organization Information – Briefly summarize your organization’s history, mission, current programs and activities.

Include an overview of your organizational structure, including board, staff and volunteer involvement. (no more than 300 words)

Stanley City is a political subdivision of North Dakota established in 1902 and has a seven-member city council. The City's mission is to provide adequate public services and establish laws to make Stanley City a better place to live, work and visit. The City provides law enforcement and public safety, fire protection, street maintenance and construction, water and sewer services, parks and recreation (swimming pool, playgrounds, dog park, softball complex, cemetery maintenance, etc.), library services and an airport. The City employs a staff of approximately 22 people and has approximate 50 volunteers including a volunteer fire department, park board members and other committees that volunteer much of their time to better the community.

Purpose of Grant – Describe the proposed project identifying how the project will meet the specific directive(s) of the Outdoor Heritage Fund Program

Identify project goals, strategies and benefits and your timetable for implementation. Include information about the need for the project and whether there is urgency for funding. Indicate if this is a new project or if it is replacing funding that is no longer available to your organization. Identify any innovative features or processes of your project. Note: if your proposal provides funding to an individual, the names of the recipients must be reported to the Industrial Commission/Outdoor Heritage Fund. These names will be disclosed upon request.

One of the primary project goals of the shared use pathway is to provide safe access to the Stanley City Pond to allow all enthusiasts access to recreation and sportsmen activities. Also, providing a connection from Main Street is important for the promotion of the recreational area and to provide adequate parking and accessible access to the shared use pathway. The shared use pathway would also provide access to a world class Scout and community facility that promotes sportsmen's activities for all ages and encourages participation of our youth. This shared use pathway would also promote a healthier lifestyle. Scouts would participate in the promotion of this recreational attraction via social media. Further, the oil has generated increased traffic in the Stanley area with Reservoir Road being one of the routes travelled making it even more essential to provide a shared use pathway to provide safe access.

If the shared use path is funded, the City will either use Oil and Gas Production Tax funding or Sales Tax funding for their share of the project along with in-kind participation by the Scouts. The planning process would begin in 2019 with completion in October of 2020 for this project. This proposed new project would move forth only if grant funding is received. Although the City recognizes the importance of this project, the City does not have funding to fully fund a shared use pathway as failing water and sewer lines and deteriorated streets has become the City's top priority.

For tree/shrub/grass plantings: provide a planting plan describing the site design, planting methods, number of trees/shrubs by species and stock size, grass species and future maintenance. A statement certifying that the applicant will adhere to USDA-NRCS tree/shrub/grass planting specifications along with the name of the governmental entity designing the planting may be substituted for a planting plan.

The applicant will adhere to the USDA-NRCS tree/shrub/grass planting specifications. The City will work closely with the Mountrail Soil Conservation District to design a planting plan.

For projects including Section 319 funding: provide in detail the specific best management practices that will be implemented and the specific projects for which you are seeking funding.

N/A

For projects including fencing: A minimum cost share of 40% by the recipient is preferred. Include detailed information on the type of fencing to be installed, whether funding is requested for boundary fencing, new or replacement of existing fencing, and/or cross fencing.

N/A

Is this project part of a Comprehensive Conservation Plan? **No**

If yes, provide a copy with the application.

Note: Projects involving buildings and infrastructure will only be considered if part of a Comprehensive Conservation Plan. Please refer to the "Definitions" section at the back of the form for more details.

Management of Project – Provide a description of how you will manage and oversee the project to ensure it is carried out on schedule and in a manner that best ensures its objectives will be met. Include a brief background and work experience for those managing the project.

The City of Stanley will hire Brosz Engineering Inc. (Brosz) for project design and to manage the project during construction to make sure project plans and deadlines are met. Brosz has been providing all phases of engineering assistance for infrastructure projects to communities in North Dakota for more than 35 years. Brosz has assisted in the development of other shared use pathway projects in the City of Stanley and in other communities in North Dakota.

Evaluation – Describe your plan to document progress and results.

Please be specific on the methods you will utilize to measure success. Note that regular reporting, final evaluation and expenditure reports will be required for every grant awarded.

Project success will be noticeable from increased usage at the City Pond and participation in activities at the Scout and community facility. This project will not only benefit the local area but will provide and attract people from surrounding areas. The Scouts along with the City will continue to make improvements at this area to provide sportsmen/recreational activities for all ages. From an economic standpoint, attracting people to this facility will benefit all of our businesses.

Financial Information

Project Budget – Use the table below to provide an itemized list of project expenses and describe the matching funds being utilized for this project.

Indicate if the matching funds are in the form of cash, indirect costs or in-kind services. The budget should identify all other committed funding sources and the amount of funding from each source. **A minimum of 25% match funding is required.** An application will be scored higher the greater the amount of match funding provided. (See Scoring Form.)

Certain values have been identified for in-kind services as detailed under "Budget Information" at the back of this form. Refer to that section and utilize these values in identifying your matching funds.

NOTE: No indirect costs will be funded. Supporting documentation for project expenses, including bids, must be included or application will be considered incomplete.

See attached detailed construction cost estimate.
(Figures Amended May 1, 2019)

| Project Expense | OHF Request | Applicant's Match Share (Cash) | Applicant's Match Share (In-Kind) | Applicant's Match Share (Indirect) | Other Project Sponsor's Share | Total Each Project Expense |
|--------------------|-------------------|--------------------------------|-----------------------------------|------------------------------------|-------------------------------|----------------------------|
| Pathway Const. | \$ 496,425 | \$ 30,175 | \$ 19,000 | \$ | \$ | \$ 545,600 |
| Trees | \$ | \$ | \$ 10,500 | \$ | \$ | \$ 10,500 |
| Preliminary Eng. | \$ | \$ 52,900 | \$ | \$ | \$ | \$ 52,900 |
| Construction Eng. | \$ | \$ 52,900 | \$ | \$ | \$ | \$ 52,900 |
| | \$ | \$ | \$ | \$ | \$ | \$ |
| | \$ | \$ | \$ | \$ | \$ | \$ |
| Total Costs | \$ 496,425 | \$ 135,975 | \$ 29,500 | \$ | \$ | \$ 661,900 |

Note: Costs for seeding, fencing, pipelines, wells, and cover crops cannot exceed NRCS Field Office Tech Guide without justification. Projects involving perimeter fencing must follow NRCS eligibility standards.

Budget Narrative – Use the space below to provide additional detail regarding project expenses.

If funding is approved, the City will contact MDU for possible donation of lighting along the shared use pathway which could be used for an in-kind match. The continued maintenance of lighting would be the City of Stanley and/or Scouts. Any matching funds not raised by in-kind donations will be covered by the City of Stanley.

Sustainability – Indicate how the project will be funded or sustained in future years.

Include information on the sustainability of this project after OHF funds have been expended and whether the sustainability will be in the form of ongoing management or additional funding from a different source.

Once constructed, the City of Stanley's Public Works Department will maintain the shared use pathway within the City and along Reservoir Road. Any trees planted will be maintained by the City of Stanley's Public Works Department and/or Scouts depending on the location. Scouts will maintain the fishing pier and pathway from the building to the dock.

Partial Funding – Indicate how the project will be affected if less funding is available than that requested.

The project would be jeopardized if less funding is awarded than anticipated. At the present the City has major infrastructure needs with deteriorated streets and failing water and sewer lines. If partial funding is provided, the City Council would make a determination on whether to move forward with the project.

If partial funding is provided, the City could complete the project in multiple phases over a longer period of time. The project could be split up into two phases, with Phase 1 as the Reservoir Road portion and Phase 2 as the 1st Avenue SE portion.

Partnership Recognition - If you are a successful recipient of Outdoor Heritage Fund dollars, how would you recognize the Outdoor Heritage Fund partnership? * There must be signage at the location of the project acknowledging OHF funding when appropriate.

The City of Stanley would publicize an article(s) recognizing the success of the project using Outdoor Heritage Fund participation. The City of Stanley and Scouts would provide signage along the shared used pathway indicating OHF was used for the project. The Scouts could use this opportunity for partnership recognition as part of a Scout project to show appreciation of OHF participation.

Awarding of Grants - Review the appropriate sample contract for your organization on the website at <http://www.nd.gov/ndic/outdoor-infopage.htm>.

Can you meet all the provisions of the sample contract? **Yes**

If there are provisions in that contract that your organization is unable to meet, please indicate below what those provisions would be:

ABOUT OHF:

The purpose of the North Dakota Outdoor Heritage Fund is to provide funding to state agencies, tribal governments, political subdivisions, and nonprofit organizations, with higher priority given to projects that enhance **conservation** practices in this state by:

Directive A. Providing access to private and public lands for sportsmen, including projects that create fish and wildlife habitat and provide access for sportsmen;

Directive B. Improving, maintaining and restoring water quality, soil conditions, plant diversity, animal systems and by supporting other practices of stewardship to enhance farming and ranching;

Directive C. Developing, enhancing, conserving and restoring wildlife and fish habitat on private and public lands; and

Directive D. Conserving natural areas and creating other areas for recreation through the establishment and development of parks and other recreation areas.

EXEMPTIONS

Outdoor Heritage Fund grants may not be used to finance the following:

- Litigation;
- Lobbying activities;

- Any activity that would interfere, disrupt, or prevent activities associated with surface coal mining operations; sand, gravel, or scoria extraction activities; oil and gas operations; or other energy facility or infrastructure development;
- The acquisition of land or to encumber any land for a term longer than twenty years; or
- Projects outside this state or projects that are beyond the scope of defined activities that fulfill the purposes of Chapter 54-17.8 of the North Dakota Century Code.

OHF funds may not be used, except after a finding of exceptional circumstances by the Industrial Commission, to finance:

- A completed project or project commenced before the grant application is submitted;
- A feasibility or research study;
- Maintenance costs;
- A paving project for a road or parking lot;
- A swimming pool or aquatic park;
- Personal property that is not affixed to the land;
- Playground equipment, except that grant funds may be provided for up to 25% of the cost of the equipment not exceeding \$10,000 per project and all playground equipment grants may not exceed 5% of the total grants per year (see Definitions/Clarifications for how this will be calculated);
- Staffing or outside consultants except for costs for staffing or an outside consultant to design and implement an approved project based on the documented need of the applicant and the expenditures may not exceed 5% of the grant to a grantee if the grant exceeds \$250,000 and expenditures may not exceed 10% of the grant to a grantee if the grant is \$250,000 or less (see Definitions/Clarifications for how this will be calculated);
- A building except for a building that is included as part of a comprehensive conservation plan for a new or expanded recreational project (see Definitions/Clarifications for definition of comprehensive conservation plan and new or expanded recreational project); or
- A project in which the applicant is not directly involved in the execution and completion of the project.

The goal of the Industrial Commission is that at a minimum 15% of the funding received for a biennium will be given priority for recreation projects that meet Directive D.

The following projects are not eligible for funding, unless there is a finding of exceptional circumstances by the Industrial Commission include:

- Construction or refurbishment of indoor/outdoor ice rinks,
- Construction or refurbishment of indoor/outdoor athletic courts and sports fields,
- Other substantially similar facilities.
- Infrastructure that is not part of a comprehensive conservation plan.
- Projects not meeting a minimum funding request of \$2,500.

Budget Information

In-kind services used to match the request for Outdoor Heritage Fund dollars shall be valued as follows:

- Labor costs \$15.00 an hour
- Land costs Average rent costs for the county as shown in the most recent publication of the USDA, National Agricultural Statistics Services, North Dakota Field Office
- Permanent Equipment Any equipment purchased must be listed separately with documentation showing actual cost. (For example: playground equipment)
- Equipment usage Actual documentation
- Seed & Seedlings Actual documentation
- Transportation Mileage at federal rate
- Supplies & materials Actual documentation

More categories will be added as we better understand the types of applications that will be submitted. We will use as our basis for these standards other State and Federal programs that have established rates. For example, the North Dakota Nonpoint Source Pollution Management Program has established rates. If your project includes work that has an established rate under another State Program, please use those rates and note your source.

Definitions/Clarifications:

Building - Defined as "A structure with a roof either with walls or without walls and is attached to the ground in a permanent nature."

Comprehensive Conservation Plan - Defined as "A detailed plan that has been formally adopted by the governing board which includes goals and objectives--both short and long term, must show how this building will enhance the overall conservation goals of the project and the protection or preservation of wildlife and fish habitat or natural areas." This does not need to be a complex multi-page document. It could be included as a part of the application or be an attachment.

New and Expanded Recreational Project means that the proposed building cannot be a replacement of a current building. The proposed building must also be related to either a new or expanded recreational project--either an expansion in land or an expansion of an existing building or in the opportunities for recreation at the project site.

Playground equipment calculation - Only the actual costs of the playground equipment (a bid or invoice showing the amount of the equipment costs must be provided) - cannot include freight or installation or surface materials or removal of old equipment, etc.

Staffing/Outside Consultants Costs - If you are requesting OHF funding for staffing or for an outside consultant, you must provide information in your application on the need for OHF funding to cover these costs. For example, if you are an entity that has engineering staff you must explain why you don't have sufficient staff to do the work or if specific expertise is needed or whatever the reason is for your entity to retain an outside consultant. If it is a request for reimbursement for staff time then a written explanation is required in the application of why OHF funding is needed to pay for the costs of that staff member(s)' time. **The budget form must reflect on a separate line item the specific amount that is being requested for staffing and/or the hiring of an outside consultant.** This separate line item will then be used to make the calculation of 5% or 10% as outlined in the law. Note that the calculation will be made on the grant less the costs for the consultant or staff.

Scoring of Grants

Oral Presentation. Please note that you will be given an opportunity to make a ten-minute Oral Presentation at a meeting of the Outdoor Heritage Fund Advisory Board. These presentations are strongly encouraged.

Open Record. Please note that your application and any attachments will be open records as defined by law and will be posted on the Industrial Commission/Outdoor Heritage Fund website.

All applications will be scored by the Outdoor Heritage Fund Advisory Board after your ten-minute oral presentation. The ranking form that will be used by the Board is available on the website at <http://www.nd.gov/ndic/outdoor-infopage.htm> .

Awarding of Grants

All decisions on requests will be reported to applicants no later than 30 days after Industrial Commission consideration. The Commission can set a limit on duration of an offer on each application or if there isn't a specific date indicated in the application for implementation of the project, then the applicant has until the next Outdoor Heritage Fund Advisory Board regular meeting to sign the contract and get the project underway or the commitment for funding will be terminated and the applicant may resubmit for funding. Applicants whose proposals have been approved will receive a contract outlining the terms and conditions of the grant.

Responsibility of Recipient

The recipient of any grant from the Industrial Commission must use the funds awarded for the specific purpose described in the grant application and in accordance with the contract. The recipient cannot use any of the funds for the purposes stated under Exemptions on the first page of this application.

If you have any questions about the application or have trouble submitting the application, please contact Andrea Pfennig at 701-328-3786 or apfennig@nd.gov.

Revised: September 14, 2018

City of Stanley
Shared Use Pathway
1st Avenue SE and Reservoir Road
Preliminary Detailed Cost Estimate
Prepared 04/24/2019



| Item Description | Unit | Quantity | Unit Cost | Amount |
|-------------------------------------|------|----------|--------------|---------------|
| Contract Bond | LSUM | 1 | \$ 10,000.00 | \$ 10,000.00 |
| Clearing & Grubbing | LSUM | 1 | \$ 5,000.00 | \$ 5,000.00 |
| Removal of Concrete | SY | 460 | \$ 25.00 | \$ 11,500.00 |
| Saw Concrete | LF | 200 | \$ 10.00 | \$ 2,000.00 |
| Topsoil | LSUM | 1 | \$ 10,000.00 | \$ 10,000.00 |
| Common Excavation - Type C | LSUM | 1,300 | \$ 30.00 | \$ 39,000.00 |
| Seeding Class III | ACRE | 2.0 | \$ 10,000.00 | \$ 20,000.00 |
| Aggregate Base Course CL 5 | TONS | 2,400 | \$ 30.00 | \$ 72,000.00 |
| Mobilization | LSUM | 1 | \$ 36,000.00 | \$ 36,000.00 |
| Traffic Control | LSUM | 1 | \$ 5,000.00 | \$ 5,000.00 |
| Hot Bituminous Pavement | Tons | 460 | \$ 200.00 | \$ 92,000.00 |
| Curb & Gutter - Type 1 | LF | 120 | \$ 80.00 | \$ 9,600.00 |
| ADA Ramps | EA | 14 | \$ 1,600.00 | \$ 22,400.00 |
| Sidewalk Concrete | SY | 720 | \$ 150.00 | \$ 108,000.00 |
| Detectable Warning Panels | SF | 120 | \$ 100.00 | \$ 12,000.00 |
| Driveway Concrete Reinforced - 6 In | SY | 120 | \$ 200.00 | \$ 24,000.00 |
| Trees | EA | 30 | \$ 350.00 | \$ 10,500.00 |
| Silt Fence Supported | LF | 1,300 | \$ 5.00 | \$ 6,500.00 |
| Signs | LSUM | 1 | \$ 10,000.00 | \$ 10,000.00 |
| 10% Contingency | LSUM | 1 | \$ 50,600.00 | \$ 50,600.00 |

Total Construction Cost = \$ 556,100

| | |
|--------------------------|----------------------|
| Preliminary Engineering | \$ 52,900.00 |
| Construction Engineering | \$ 52,900.00 |
| Total Cost | \$ 661,900.00 |

| | |
|------------------------------|---------------|
| Local Share (25%) | \$ 165,475.00 |
| Grant Request | \$ 496,425.00 |
| 100 LF of Shared Use Pathway | \$ 19,000.00 |
| Trees | \$ 10,500.00 |
| Cash | \$ 135,975.00 |

100 LF of Shared Use Pathway
Trees

In-Kind
In-Kind
Cash

Boy Scout Troop 1357
Boy Scout Troop 1357
City of Stanley

PLAN NARRATIVE

The pathway would begin at Main Street and proceed along the north side of 1st Avenue SE. The first block from Main Street to 1st Street SE already has newer wider sidewalk with ADA ramps, so no new construction would be proposed on this block. However, there would be signs on Main Street to promote the use of the pathway and Main Street would serve as the west "trailhead", where there is ample on street parking and business destinations.

From 1st Street SE to 3rd Street SE, the existing 5' wide sidewalk is in poor condition and the ramps do not meet ADA compliance. The sidewalk on these two blocks would be removed and replaced with a new 9 foot wide concrete shared use pathway with new ADA ramps. This would also include replacement of portions of 5 driveway and alley approaches. There is approximately 650 LF of new concrete shared use pathway and 6 ADA ramps that would be constructed.

After the pathway crosses 3rd Street SE, it turns into a 9 feet wide asphalt paved pathway that will be constructed of 4" of hot bituminous pavement and 8" of aggregate base. The pathway will begin at 3rd Street SE and run eastward along the north side of Reservoir Road. It will abut up against the east side of the Stanley Pond shoreline, then enter the Stanley Pond and Stanley Scout property. The pathway will then extend north to the existing fishing dock. An accessible pathway will also be constructed from the new Scout Building down to the fishing dock. There will be two ADA parking stalls in the parking lot of the new Scout property. The new parking lot will have 22 parking stalls and will serve as the east trailhead. This portion of the pathway includes approximately 1,350 feet along the north side of Reservoir Road, 300 feet from Reservoir Road to the fishing dock, and 170 feet from the new Scout building to the fishing dock. It would also include construction of at least 8 ADA ramps.

The total length of the pathway from Main Street to the fishing dock plus the extension to the Scout building is approximately 2,900 feet, with 2,470 feet of proposed new construction.

STANLEY SHARED USE PATH

NEW OR EXISTING 9 FT PATHWAY

PATH TYPE

- EXISTING SIDEWALK
- NEW PATH

PATH SURFACE TYPE

- ASPHALT
- CONCRETE

STANLEY SCOUT FACILITY

Stanley Scout Facility

Stanley City Pond

Barrier Free Fishing Dock

RESERVIOR RD

RAILROAD AVENUE

1ST ST SE

2ND ST SE

3RD ST SE

MAIN ST S

Stanley, ND



Sources: Esri, DigitalGlobe, GeoEye, Earthstar Geographics, CNES/Airbus DS, USDA, USGS, AeroGRID, IGN, and the GIS User Community

New Scout Facility
Multi-Purpose Room

New Scout Facility
Multi-Purpose Room



New Scout Facility
6 Lane Indoor Shoot Range With Barrier Free Stall



New Scout Facility
6 Lane Indoor Shooting Range



New Scout Facility
Commercial Kitchen



New Scout Facility
Commercial Kitchen

DATE PRINTED: xxx/xxx/xx
 DRAWN BY: NJB
 DESIGNED BY: ZJG
 DATE: xxx/xxx/xx

| REVISION | DATE |
|----------|------|
| | |
| | |
| | |

PROJECT NO.: N16-ST355
 PROJECT NAME: RESERVOIR ROAD
 SHEET DESCRIPTION: PLAN & PROFILE SHEETS



This document is preliminary and shall not be used for construction or implementation purposes.

INSTALL ADA COMPLIANT DETECTABLE WARNING PANELS AT THE FOLLOWING LOCATIONS:
 5+90 - 15' LT (20 SF)
 6+27 - 15' LT (20 SF)
 6+32 - 15' LT (20 SF)
 6+79 - 15' LT (20 SF)
 8+53 - 15' LT (20 SF)
 9+11 - 15' LT (20 SF)

INSTALL CURB & GUTTER AT THE FOLLOWING LOCATIONS:
 4+50 - 15' LT TO 6+03 - 26' LT (165 LF)
 6+19 - 26' LT TO 6+47 - 26' LT (40 LF)
 6+67 - 26' LT TO 6+63 - 26' LT (220 LF)
 8+98 - 26' LT TO 9+25 - 15' LT (40 LF)
 4+50 - 15' RT TO 5+79 - 44' RT (150 LF)
 6+08 - 44' RT TO 6+50 - 15' RT (60 LF)

INSTALL DRIVEWAY CONCRETE 6IN REINFORCED APRON AT THE FOLLOWING LOCATIONS:
 6+56 - LT (55 SY)
 9+80 - LT (125 SY)

INSTALL 72IN VALLEY GUTTER APRON AT THE FOLLOWING LOCATIONS:
 6+56 - LT (19 SY)
 9+80 - LT (27 SY)

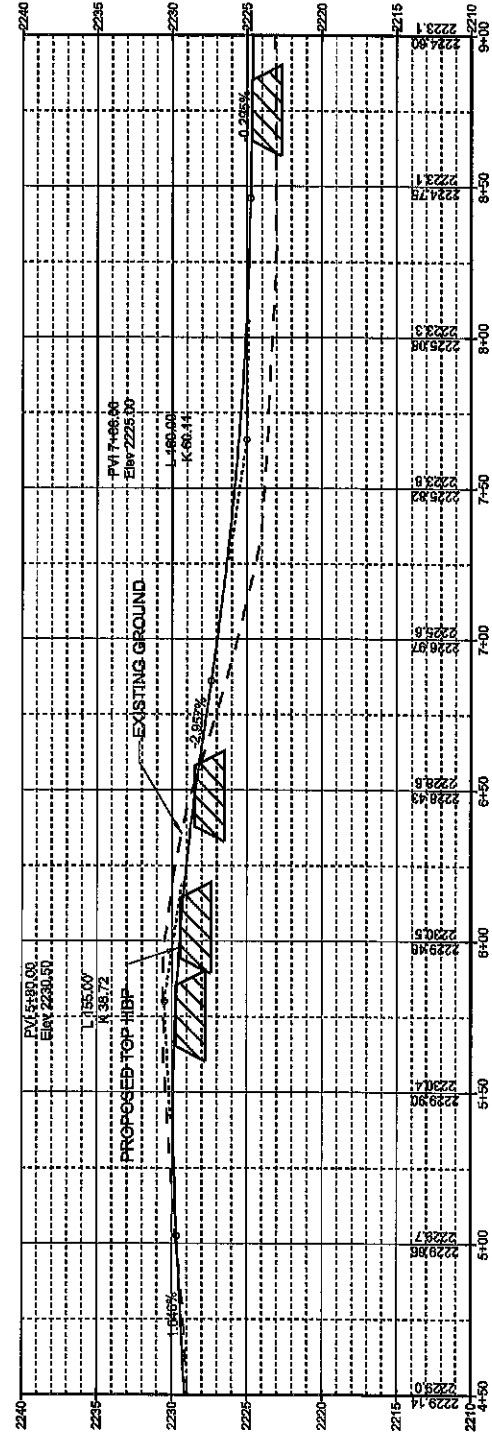
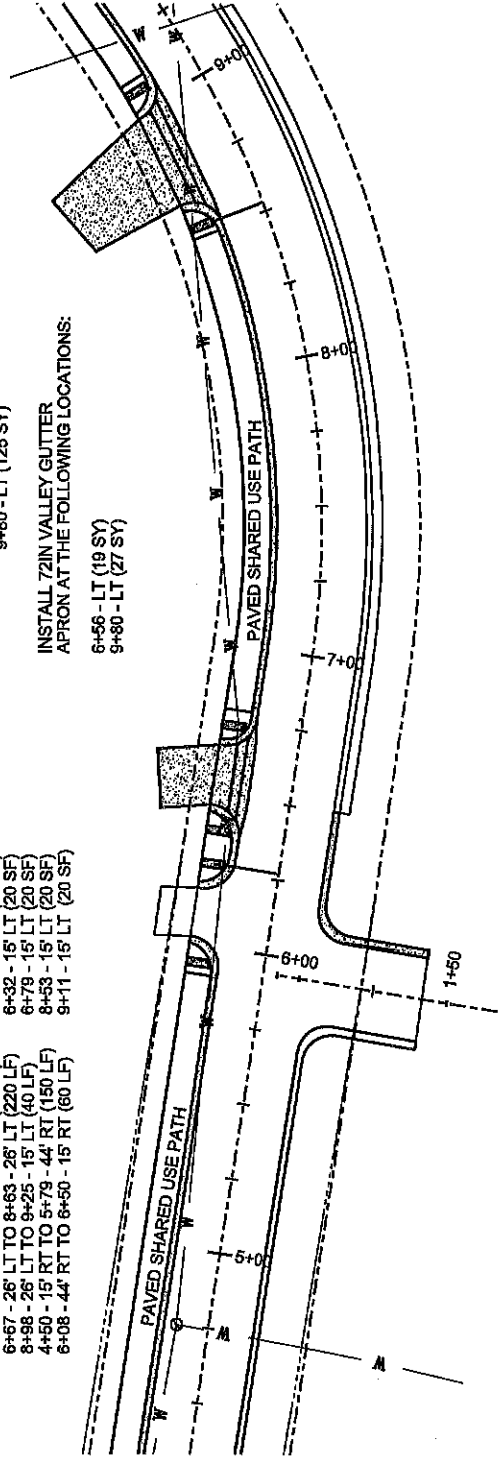



PROJECT NAME: RESERVOIR ROAD
 PROJECT NO: N16-ST365
 SHEET DESCRIPTION: PLAN & PROFILE SHEETS

| DATE | REVISION |
|------|----------|
| | |
| | |
| | |

DESIGNED BY: ZJG
 DRAWN BY: NJB
 DATE PRINTED: x/x/x/xx

This document is preliminary and for informational purposes only. It is not to be used for construction or implementation purposes.

Scale: 1"=40.00'

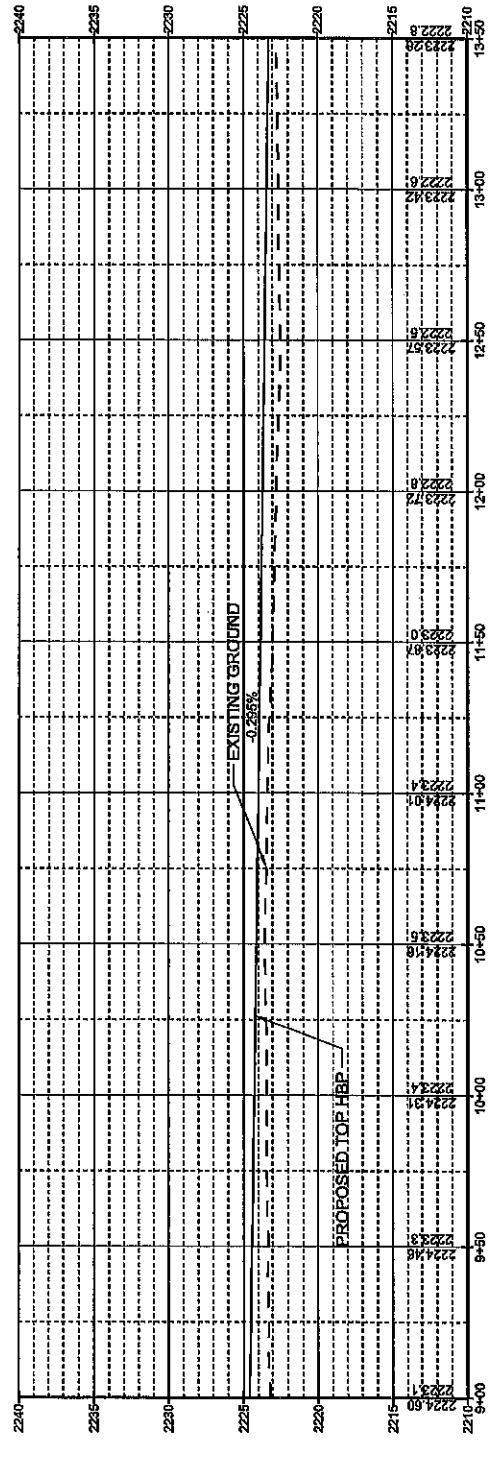
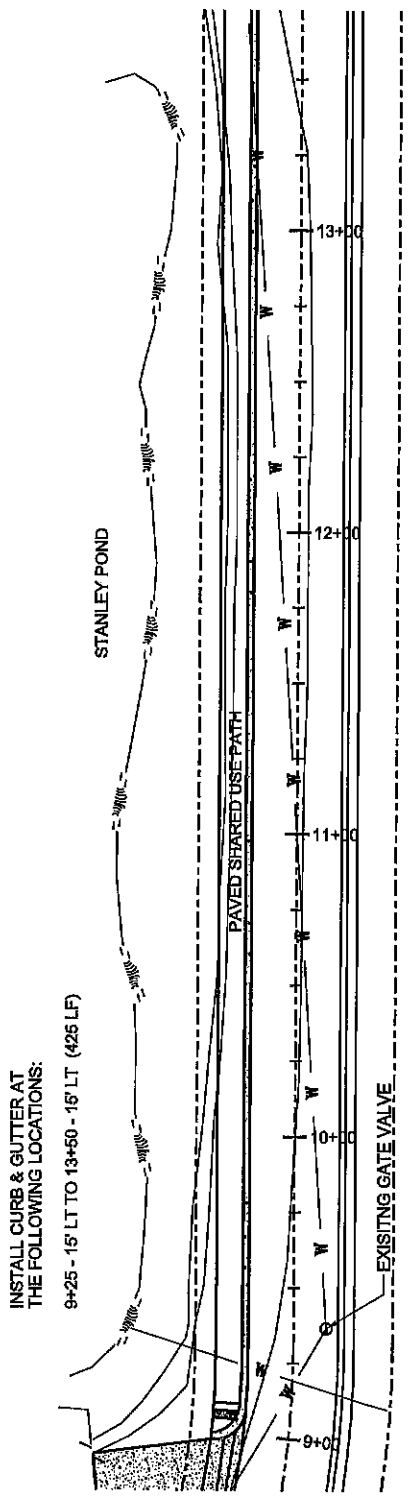

| | | | | |
|----------|----------|------------------|---------------|--------------------------|
| XX OF XX | DATE | DESIGNED BY: ZJG | DRAWN BY: NJB | DATE PRINTED: xxx/xxx/xx |
| | REVISION | | | |
| | 1 | | | |
| | 2 | | | |
| | 3 | | | |
| | 4 | | | |

SHEET DESCRIPTION: PLAN & PROFILE SHEETS
 PROJECT NAME: RESERVOIR ROAD
 PROJECT NO.: N16-ST355



This document is preliminary and is for information or consultation purposes only. It is not to be used for construction or implementation purposes.

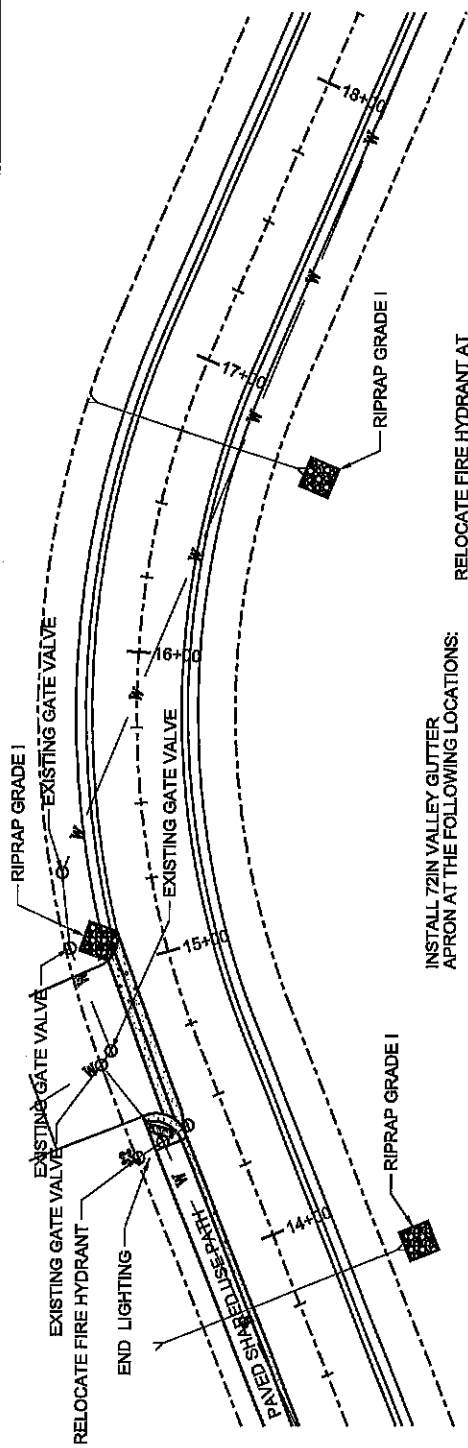

- INSTALL ADA COMPLIANT DETECTABLE WARNING PANELS AT THE FOLLOWING LOCATIONS:
14+29 - 15' LT (20 SF)
- INSTALL 72IN VALLEY GUTTER APRON AT THE FOLLOWING LOCATIONS:
14+72 - LT (40 SF)
- INSTALL CURB & GUTTER AT THE FOLLOWING LOCATIONS:
13+50 - 15' LT TO 14+42 - 26' LT (105 LF)
- RELOCATE FIRE HYDRANT AT THE FOLLOWING LOCATIONS:
14+40 - 34' LT (1 EA)
- INSTALL 6" PVC AT THE FOLLOWING LOCATIONS:
14+40 - 22' LT TO 34' LT (20 LF)

